

Typical usage: Speed sensing of a ferrous target (gear tooth, blade tip, bolt head, keyway, etc.)
Produces an analog signal with the voltage and frequency proportional to the speed.
Inductive (MI) type sensors for magnetic targets are available in 5/8 and larger housing styles.

Output Voltage (Vpp): See below. Determined against 20 DP gear at a velocity of 1000 IPS with an air gap of 0.005".

Air Gap: **M VRS Type:** .005 to .015" Typical, .25" max. depending on target mass and velocity.
MI Inductive Type: 1" max. depending on magnetic field strength and velocity.

Temp. Ranges: **2T:** -100° to 250° F (-73° to 120° C)
3T: -150° to 330° F (-101° to 165° C)
5HT: -450° to 450° F (-270° to 232° C)
8HT: -450° to 850° F (-270° to 454° C) (see bottom of next page)

Please contact info@spectecsensors.com for detailed spec-sheets on each sensor family listed.

3/16" Thread Length: .65 - 2.5" (17-64mm)
M5 Coil Type 1: 100 Ohm; 16mH; 6Vpp
Temp Ranges: 3T or 5HT

0002 10-32 UNF
0002M M5 x 0.5
0002S ø3/16 (4.7mm)



1/4" Thread Length: 1.0 - 3.0" (25-76mm)
M6 Coil Type 1: 100 Ohm; 10 mH; 6 Vpp
Coil Type 2: 160 Ohm; 14 mH; 12 Vpp
M8 Temp Ranges: 3T or 5HT

0004A 1/4-40 UNS
0004AB 1/4-28 UNF
0004AM M6 x 0.75
0004AM8 M8 x 1.0
0004S ø1/4 (6.4mm)
0004S8 ø5/16 (8 mm)

0005 1/4-40 UNS
0005B 1/4-28 UNF
0005M M6 x 0.75

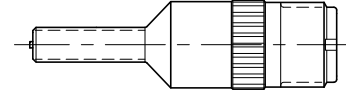

0004 1/4-40 UNS
0004B 1/4-28 UNF
0004M M6 x 0.75
0004H 1/4-40 UNS
0004HB 1/4-28 UNF
0004HM M6 x 0.75



3/8" Thread Length: .8 - 5.0" (20-127mm)
M10 Coil Type 1: 100 Ohm; 10 mH; 25 Vpp
Coil Type 2: 230 Ohm; 40 mH; 70 Vpp
Coil Type 3: 650 Ohm; 120 mH; 85 Vpp
Temp Ranges: 2T, 3T, or 5HT

0008 3/8-24 UNEF
0008M M10 x 1.25
0008M1 M10 x 1.0
0008S ø3/8 (9.5mm)

0009 3/8-24 UNEF
0009M M10 x 1.25

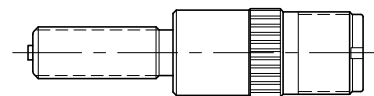

0007 3/8-24 UNEF
0007M M10 x 1.25

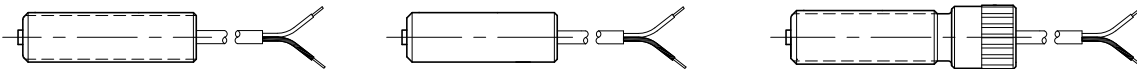

1/2" Thread Length: 1.0 - 6.0" (25-152mm)
M12 Coil Type 1: 140 Ohm; 20 mH; 30 Vpp
Coil Type 3: 650 Ohm; 160 mH; 85 Vpp
Coil Type 5: 1800 Ohm; 800 mH; 230 Vpp
Temp Ranges: 2T, 3T, or 5HT

0010A 1/2-20 UNF
0010B 1/2-32 UN
0010M M12 x 1.0
0010S ø1/2 (13mm)

0011 1/2-20 UNF
0011M M12 x 1.0

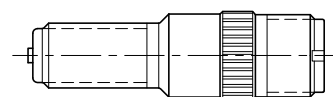

0011MD M12 x 1.0
0010X 1/2-20 UNF

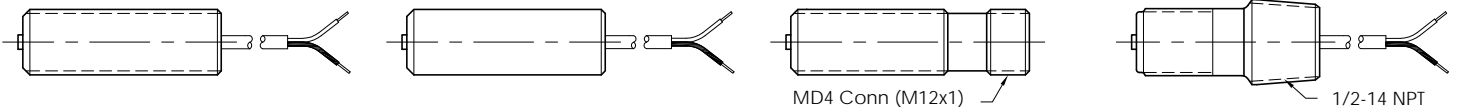

MD4 Conn (M12x1)

1/2-14 NPT

CONTINUED...

Please contact info@spectecsensors.com for detailed spec-sheets on each sensor family listed.

...CONTINUED

5/8" Thread Length: .8 - 10.0" (20-250mm)
M16 Coil Type 1: 70 Ohm; 25mH; 40Vpp (Power)
 Coil Type 2: 150 Ohm; 85mH; 50Vpp
 Coil Type 3: 230 Ohm; 120mH; 70Vpp
 Coil Type 4: 1100 Ohm; 450mH; 180Vpp (Standard)
 Coil Type 5: 1500 Ohm; 800mH; 230Vpp
 Coil Type 6: 3000 Ohm; 1500mH; 290Vpp (High Output)
 Coil Type 7: 5000 Ohm; 2500mH; 330Vpp
 Temp Ranges: 2T, 3T, or 5HT

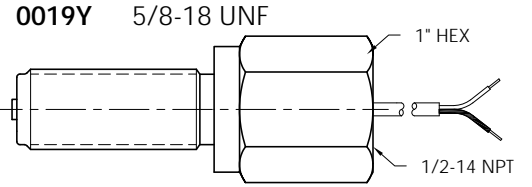

0015 5/8-18 UNF
0015M M16 x 1.5
0015M1 M16 x 1.0

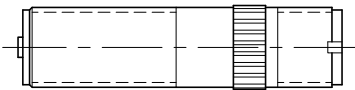

0017 5/8-18 UNF
0017M M16 x 1.5
0017M1 M16 x 1.0

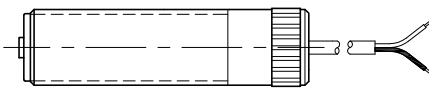

0019 5/8-18 UNF
0019M M16 x 1.5
0019M1 M16 x 1.0

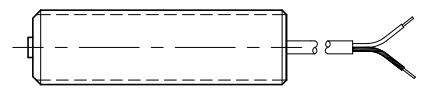

0014 5/8-18 UNF

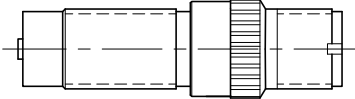

0018B 5/8-18 UNF

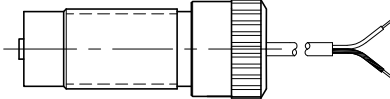

0019X 5/8-18 UNF

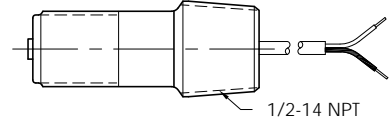

11/16" Thread Length: .8 - 3.5" (20-89mm)
 Coil Types: 4 through 7 (see above)
 Temp Ranges: 2T, 3T, or 5HT

0026 11/16-24 UNEF

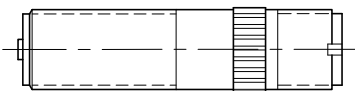

0026H 11/16-24 UNEF

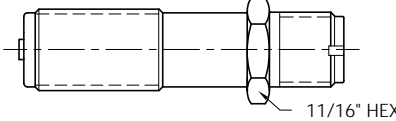

0033 11/16-24 UNEF

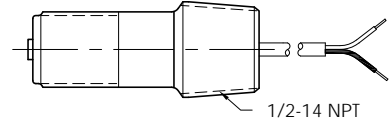

0027 11/16-24 UNEF

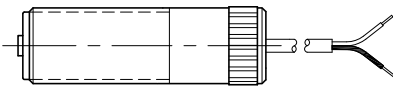

0027H 11/16-24 UNEF

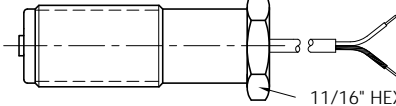

3/4" Thread Length: .9 - 10.0" (23-250mm)
M18 Coil Types: 1 through 7 (see above)
 Temp Ranges: 2T, 3T, or 5HT

0030 3/4-16 UNF
0030B 3/4-20 UNEF
0030M M18 x 1.5
0030M1 M18 x 1.0

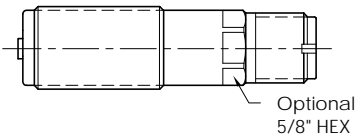

0029 3/4-16 UNF
0029B 3/4-20 UNEF
0029M M18 x 1.5
0029M1 M18 x 1.0

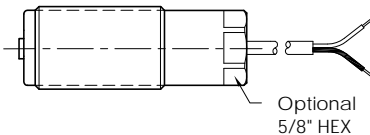

0038 3/4-16 UNF
0038B 3/4-20 UNEF

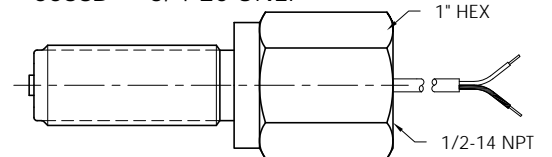

0035 3/4-16 UNF
0035B 3/4-20 UNEF

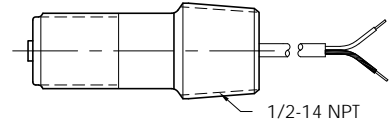

8HT HIGH TEMP Temp Range: -450° to 850° F (-270° to 454° C)
 Available in the same housing configurations shown on this page.

0024 Connector versions
0025 Lead Wire versions

DUAL OUTPUT

Two coils inside the same housing. Available in the same housing configurations and temperature ranges shown on this page.

0021 Connector versions
0022 Lead Wire versions