

PRODUCT DESCRIPTION

SPECTEC's DIGISPEC Magnetic pickups produce a digital frequency output proportional to speed. The internal amplifier provides for constant pulse shaping, signal amplitude, logic-level output, robust signal-to-noise ratio, usable at lower RPMs and greater air gap between the sensor and the actuator. All models are also available with an internal temperature probe.

For hazardous location Class 1 Division 1 please refer to IS90 & IS91, or for Class 1 Division 2 please refer to N90 & N91.

SPECIFICATIONS

- Vs, Supply Voltage:** 7.5(12) to 30 VDC regulated
 4.5 to 7.5 VDC, unregulated
- Is, Supply Current:** ≤ 20 mA @ 30 VDC (Max.)
- Vo, Signal Out:** @ ≤ 20 mA sink, See page 2
- Input Sensitivity:** 30, 12, or 5 mVpp
- Operating Freq.:** ~ 3 to 10 kHz
 ~ 30 kHz at increased signal level, varies with target size, distance and pickup sensitivity. (Options: ≤ 100 kHz)
- Rise/Fall Time:** 0.04 μs / 0.16 μs
- Temperature Range:** 2TE: -40° to 257°F (-40° to 125°C)
 3TE: -49° to 284°F (-45° to 140°C)
- Magnetization:** Standard: ≥ 900 Gauss, TYP.
 Low Mag: 250 Gauss, TYP. See Pg. 2 Note
- Pole Piece:** Flush (FP), Sealed Flush, (FPS), Extended (EP), Sealed Extended (EPS)

Gear Pitch	Pole Type
≤24 DP (MODULE 1.06)	FP130, FPS130
	EP106, EP125,
	EPS130

- Connectors:** See Page 2 for Configurations
 All have Gold Plated Contacts
- Lead Wire & Assignments:** See Page 2 for Wire & Cable Options
 2TE: PVC, 20-24 AWG (105°C max)
 3TE: TFE, 20-24 AWG
 Red: Supply (+)
 Black: Common (-)
 White or Green: Signal Out
 Bare: Shield

Construction: 300 Series stainless steel housing
 Solid epoxy encapsulation

CE-Compliance: EN55011, EN50082-2

OPTIONS

Custom configurations, thread sizes, outputs, special materials of construction, temperature probes (NTC10, RTD100, or others) are available. Please contact sales for more information.

0092 11/16-24 UNEF

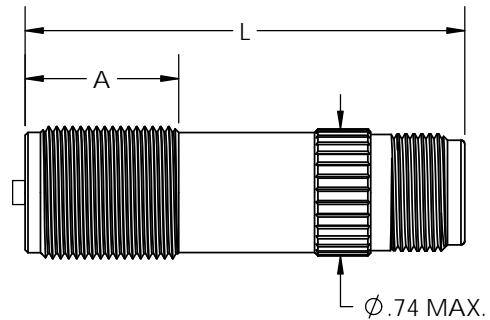

0092H 11/16-24 UNEF

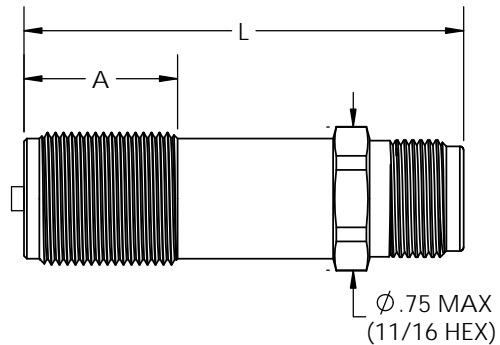

0093 11/16-24 UNEF

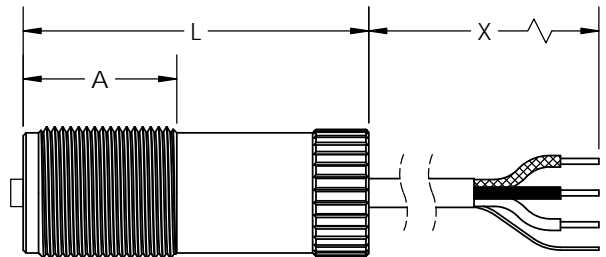

0093X 11/16-24 UNEF with 1/2-14 NPT Male

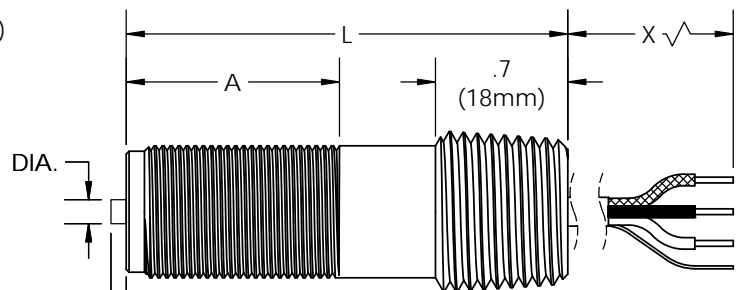

Pole Types, See Page 2

ORDER INFORMATION

STYLE: **OPTIONS:** **THREADS/DIA.:**
0092 - **11/16-24 UNEF**
0092H - **11/16-24 UNEF**

Thread (A) & Housing (L) Length:

	A	L
2	1.1" (28mm)	2.75" (70mm)
4	1.3" (33mm)	3.5" (89mm)

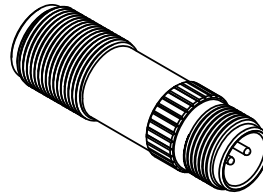

Connector Pinouts

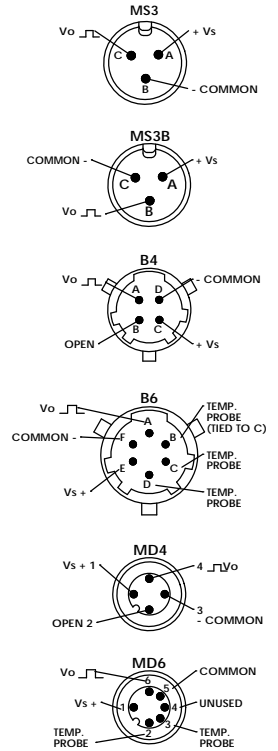

Pole Type (Ø, H):

1	- FP130	Flush Pole, Ø.130
2	- EP125	Extended Pole, Ø.125" x .065" H
3	- EP106	Extended Pole, Ø.106" x .020" H
5	- FPS130	Flush Pole, Ø.130 in Sealed S.S. Face
6	- EPS125	Extended Pole, Ø.125" x .065" H in Sealed S.S. Face

Vo, Pulse Out/ Output Logic:

1	- 0-10V, NPN (Recommend Vs=12 VDC min)
2	- 0-5V, NPN [TTL]
3	- 0-Vs, NPN w/2.2k pull-up
4	- 0-Vs, NPN (OC), Open collector
5	- 0-Vs, Sink/Source w/Short Circuit Protection (85°C max)
6	- 0-5V, Sink/Source w/Short Circuit Protection (85°C max)
7	- 0-Vs, Sink/Source (125°C max)
8	- 0-5V, Sink/Source (125°C max)

Input Sensitivity and Temp.:

1	- 30 mV (2TE, 125°C)
2	- 12 mV (2TE, 125°C)
3	- 5 mV (2TE, 125°C)
5	- 30 mV (3TE, 140°C)
6	- 12 mV (3TE, 140°C)
7	- 5 mV (3TE, 140°C)

Connector:

1	- MS3:	3 Pin	MS3106-10SL-3P (See Bulletin 3000)
3	- MS3B:	3 Pin	MS3102-10SL-3P (See Bulletin 3000)
4	- B4:	4 Pin	Bayonet, MS3113-H8A-4P (See Bulletin 3001)
5	- B6:	6 Pin	Bayonet, MS3111-H10A-6P (See Bulletin 3001)
7	- MD4:	4 Pin	Micro DIN (See Bulletin 3005)
8	- MD6:	6 Pin	Micro DIN (See Bulletin 3005)

0093 - **11/16-24 UNEF**

Thread (A) & Housing (L) Length:

	A	L
1	1.10" (28mm)	2.25" (57mm)
2	1.30" (33mm)	3.0" (76mm)

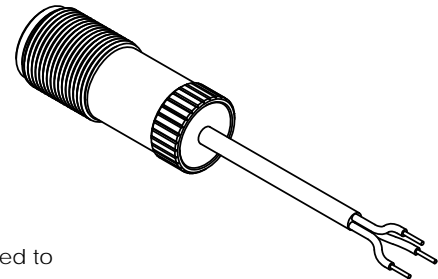

Lead Wire(X):

1	- 1' (.3m)	Single Leads
2	- 2' (.6m)	Single Leads
7	- 3' (1m)	Shielded Cable
9	- 10' (3m)	Shielded Cable
A	- 20' (6m)	Shielded Cable

Note: Cable Shielding is not connected to sensor, and is intended to be connected to the instrument ground.

0093X - **11/16-24 UNEF with 1/2-14 NPT Female**

Thread (A) & Housing (L) Length:

	A	L
1	.70" (18mm)	1.9" (48mm)
2	1.3" (33mm)	2.6" (66mm)

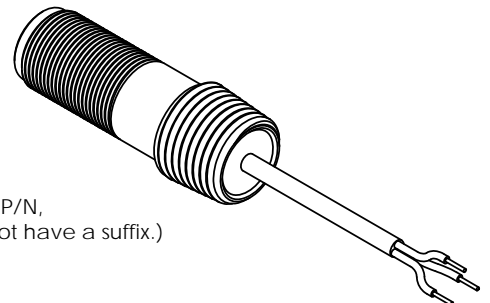

Notes: 1. The magnetization level for special or low mag. sensors, is designated as a suffix to the P/N, i.e.:0093 -xxxx-300G, designating a gauss level of 300(±50). (Standard mag. level will not have a suffix.)