



PRODUCT DESCRIPTION

SPECTEC's unique dual and triple output magnetic pickups are part of a modular family of high performance, passive, variable reluctance sensors (VRS). The multi output is designed for pulse security applications where a redundant high reliability output is a must. It may be used in place of two separate sensors, providing component and installation savings. An integral temperature sensor is available as an option.

SPECIFICATIONS

DC-Coil Resistance/Inductance, Output Voltage:

- Type 1: (x2)150/300Ω (x3)150/300/450Ω 150 mH 60 Vpp
- Type 2: (x2)300/450Ω (x3)300/450/600Ω 150 mH 60 Vpp
- Type 4: (x2)600/900Ω (x3)600/900/1200Ω 300 mH 100 Vpp
- Type 5: (x2)900/1350Ω 500 mH 150 Vpp

(When tested at 1000 IPS against 20 pitch, 30 tooth gear at .005" gap, 100k Ohm load. Inductance and output voltage notations are maximum values.)

Magnetization:

- Standard: 1100 Gauss, typ.
- Low Mag: 250 Gauss, typ.

Temperature Range:

- 2T: -100° to 260° F (-73° to 125°C)
- 3T: -150° to 330° F (-101° to 165°C)
- 5HT: -450° to 450° F (-268° to 232°C)

With temperature probe:

RTD 100 Ohm platinum probe:
 -330° to 450° F (-201° to 232°C)

NTC 10 kOhm thermistor:
 -40° to 260° F (-40° to 125°C)

Pole Piece:

Flush (FP), Extended (EP) and Chisel Points (CP) are available. (Chisel must be oriented parallel with gear tooth.)

All illustrations are shown w/flush pole (FP).

0022Y is shown w/extended pole (EP).

To optimize performance please note gear pitch/pole piece recommendations:

Gear Pitch	Pole Piece
≤ 36 DP (Module 0.7)	EP62, CP10
≤ 26 DP (Module 0.98)	EP93
≤ 24 DP (Module 1.06)	FP, EP106, EP125, CP45
≤ 12 DP (Module 2.11)	EP188
≤ 5 DP (Module 5.1)	EP250

Construction:

300 series S.S., Solid Epoxy Encapsulation

Lead Wire 'x':

20 AWG, PVC or Teflon insulated
 See page 2 for options.

CE-Compliance:

EN55011, EN50082-2

OPTIONS:

For different length, material of construction, configuration, special pole-piece types, thread size, hermetically sealed, precision custom magnetization, connector and-or cable termination, please contact factory.

For connector type, refer to: 0021

0022

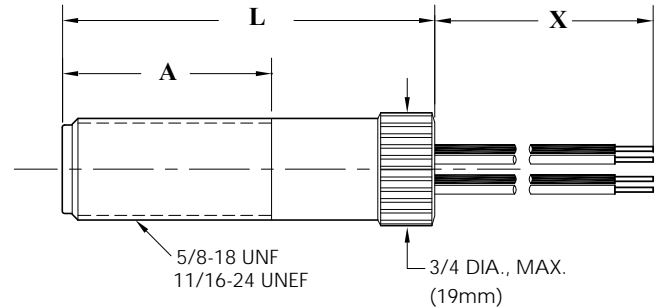

0022A
0022M

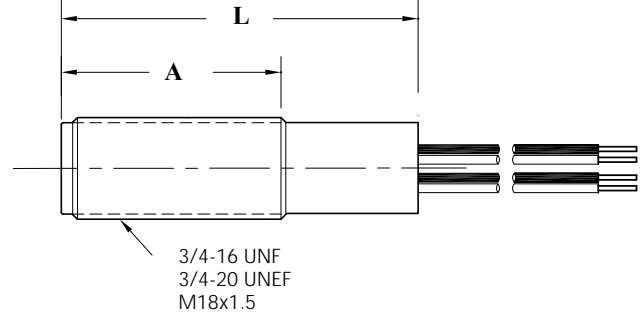

0022X

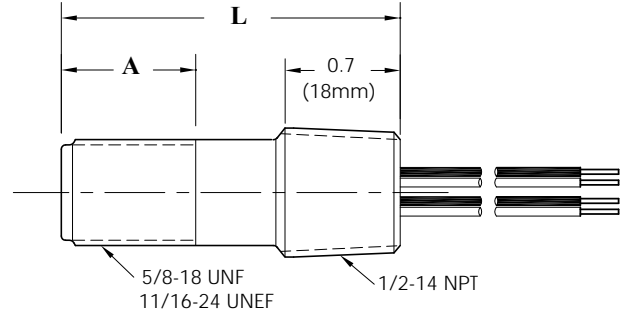

0022Y

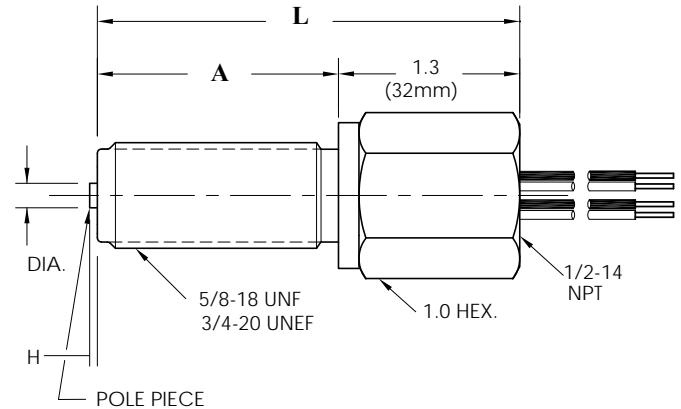

SPECTEC P/N	Thread	A	L	Coil Type	Pole Piece	Temp Range	x
0022-xx	5/8 - 18	0.7 - 8.0 (18-200mm)	1.0 - 8.5 (25 - 216mm)	Type 1 (x2)* 150/300Ω	FP (.130 DIA)	2T	12" (0.3m)
	1 1/16 - 24	0.7 - 1.5 (18 - 38mm)	1.0 - 3.0 (25 - 76mm)	Type 2 (x2)* 300/450Ω Power Output	EP62 (.062 DIA. x .03H) EP93 (.093 DIA. x .03H)	3T 5HT	36" (1m) 60" (1.5m)
0022A-xx	3/4 - 16	0.7 - 4.0 (18 - 101mm)	1.0 - 4.5 (25 - 114mm)	Type 4 (x2)* 600/900Ω Std. Output	EP106 (.106 DIA. x .02H) EP125 (.125 DIA. x .07H)	RTD 100 NTC 10	120" (3m) 300" (7.6m)
	3/4 - 20						
0022M-xx	M16x1.5 M18x1.5 M22x1.5	0.7 - 4.0 (18 - 101mm)	0.7 - 4.5 (18 - 114mm)	Type 5 (x2)* 900/1350Ω High Output	EP187 (.187 DIA. x .02H) EP250 (.250 DIA. x .02H)		
0022X-xx	5/8 - 18	0.7 - 1.3 (18 - 33mm)	1.8 - 2.5 (46 - 64mm)	Type 1 (x3)* 150/300/450Ω	CP10 CHISEL (.010 W) CP45 CHISEL (.045 W)		
	1 1/16 - 24			Type 2 (x3)* 300/450/600Ω			
0022Y-xx	5/8 - 18	1.0 - 6.0 (25 - 152mm)	2.5 - 7.3 (64 - 185mm)	Power Output Type 4 (x3)* 600/900/1200Ω Std. Output	FPS & EPSxxx (Versions with Stainless Steel sense end)		
	3/4 - 20	1.9 - 6.0 (48 - 152mm)	3.1 - 7.3 (79 - 185mm)				

When ordering, please specify features selected from the above table

x2*: dual output settings

x3*: triple output settings

Specific Models:

0022-01	5/8 - 18	1.3 (33mm)	2.0 (51mm)	Type 4	FP	3T	12"
0022-03		3.0 (76mm)	3.6 (91mm)		EP92		
0022-04		1.8 (46mm)	2.5 (64mm)	Type 2	EP106	36"	
0022-06	5/8 - 18	4.0" (101mm)	4.7" (119mm)	Type 2	FP	2T	12"
0022A-01	3/4 - 16	2.5" (64mm)	3.0 (76mm)	Type 5	FP200	3T	
0022A-02		3.5" (89mm)	4.0" (101mm)	Type 2	FP160	2T	
0022A-03		2.5" (64mm)	3.0 (76mm)	Type 4 (x3)	FP200	3T	
0022A-07	5/8 - 18	4.0" (101mm)	4.0" (101mm)	Type 2	FP130	2T	
0022M-01	M18x1.5	2.0 (51mm)	2.5 (64mm)	Type 4	FPS160	3T	50cm
0022M-01C	M22x1.5	65mm	80mm	Type 4	FP250	2T	30cm
0022M-02C		46mm	70mm	Type 4	FP250		
0022Y-01	5/8 - 18	1.1 (28mm)	2.4 (61mm)	Type 4	EP93	3T	60"
0022Y-02	3/4 - 20	1.9 (48mm)	3.1 (79mm)	Type 4	EPS93		36"
0022Y-02L20							240"
0022Y-03	5/8 - 18	2.0 (51mm)	3.2 (81mm)	Type 4	FPS		120"
0022Y-04		4.0 (101mm)	5.2 (132mm)	Type 4	EPS93	200"	

Note: The magnetization level for special or low magnetic drag sensors, is called out as a suffix to the part number, ie: 0022-xx-300g designating a gauss level of 300. (Standard magnetic level (up to 1200G) will not have a suffix.)